

3  
2  
1  
0  
SCALE  
1"=1'

4  
2  
0  
SCALE  
3/4"=1'

6'  
3'  
2'  
1'  
0  
SCALE  
1/2"=1'

12  
8  
4  
0  
SCALE  
1/4"=1'

20  
10  
0  
SCALE  
1/8"=1'

40  
20  
10  
0  
SCALE  
1/16"=1'

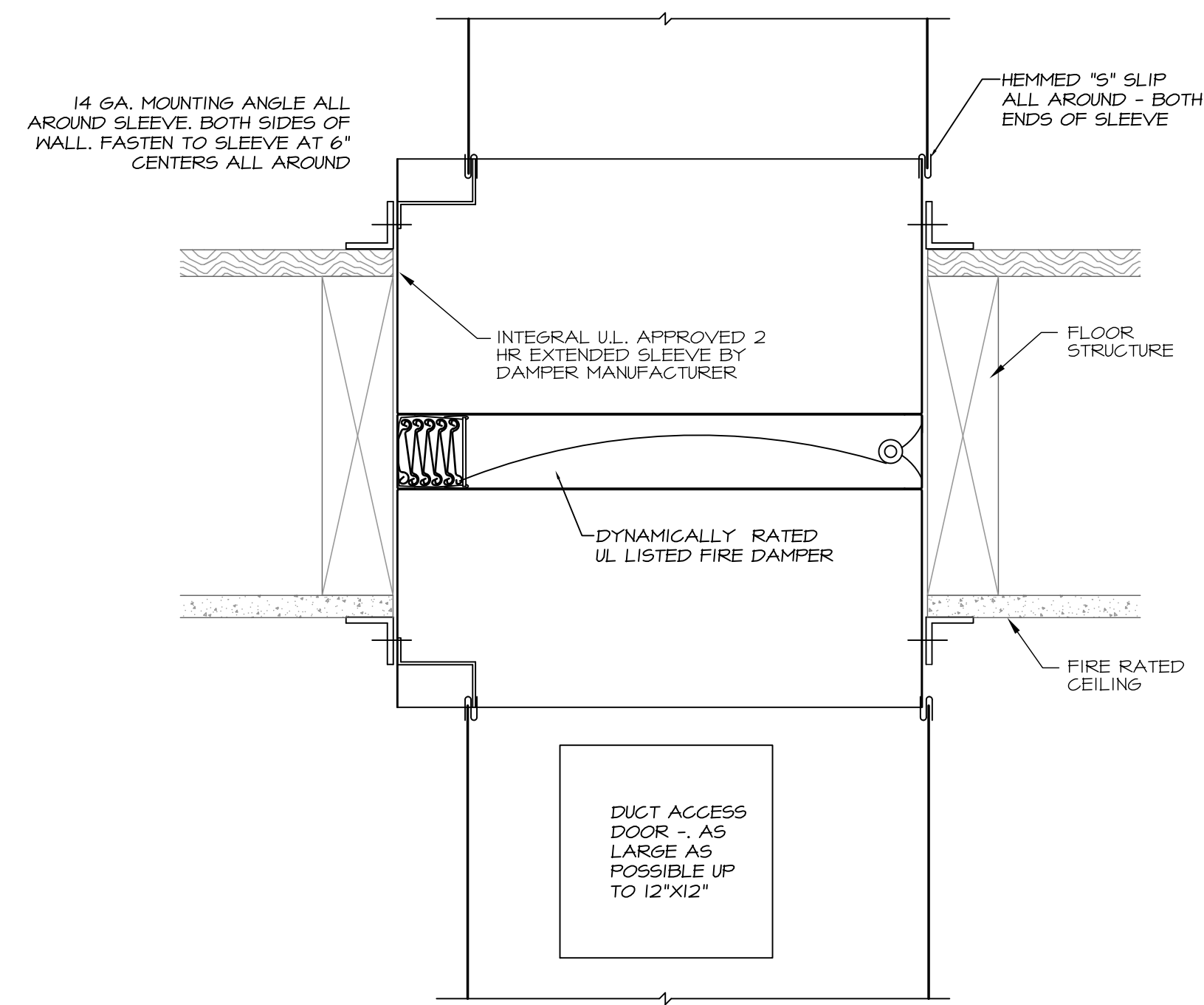

NOTE: SEE PLANS FOR DUCT AND DAMPER SIZING.

1 FLOOR FIRE DAMPER STYLE "B"  
NO SCALE

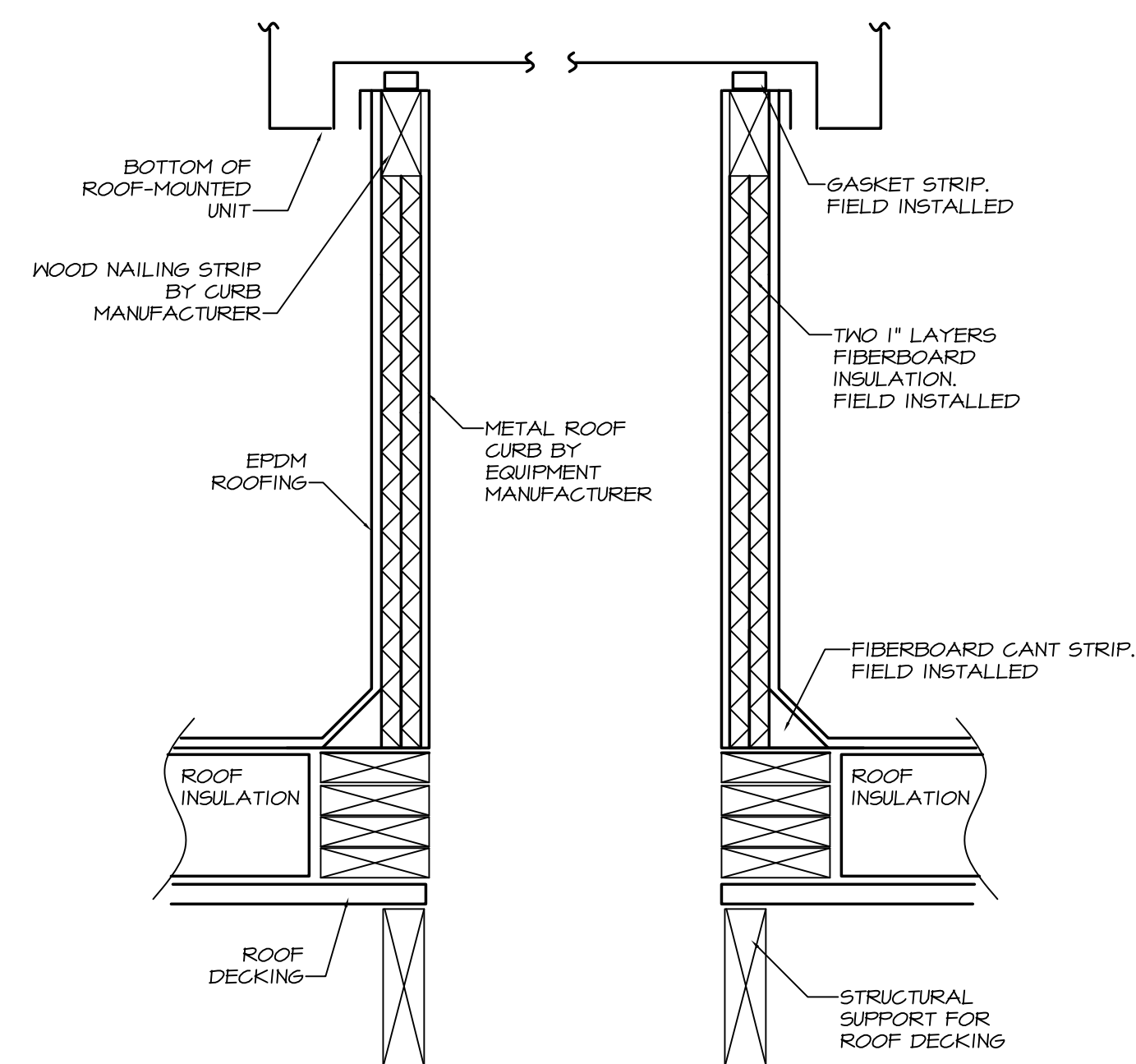

2 ROOF CURB DETAIL  
NO SCALE

**SHEETMETAL NOTES**

1. All ductwork to be fabricated and installed per SMACNA Low Pressure Ductwork Standards.
2. Ductwork is shown diagrammatically and does not indicate all the offsets, rises and drops that will be required.
3. All square elbows are to be installed with turning vanes.
4. Flexible ductwork to be insulated with 1-1/2" fiberglass duct wrap with foil-faced vapor barrier. Flexible ductwork to be UL181 listed and limited to a maximum run of 6'-0".
5. All supply ductwork to be insulated with 1-1/2" fiberglass duct wrap with foil faced vapor barrier.

**CONTROL NOTES**

1. It will be the Mechanical Contractor's responsibility to provide and install all controls and all control wiring.
2. All control wiring that is run in concealed spaces to be plenum rated.
3. All control wiring that is run exposed shall be in electrical conduit provided and installed by the mechanical contractor.
4. All thermostats to be electronic programmable with 7-day programming.

**GENERAL NOTES**

1. All systems are to be to meet the following Codes and Standards.
  - 1.1. ASHRAE 90.1 2007 - Energy Standard for Commercial Buildings.
  - 1.2. ASHRAE 60.1 2007 - Standard for Indoor Air Quality in Commercial Buildings.
  - 1.3. 2009 IECC - International Energy Conservation Code.
  - 1.4. NFPA - National Fire Protection Association Standards.
2. Do not cut any structural members with pre-approval of structural engineer.

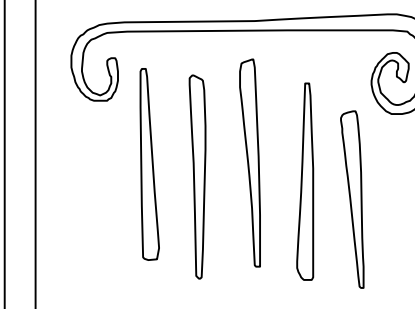

PORT CITY ARCHITECTURE

65 NEWBURY STREET  
PORTLAND, ME 04101  
207.761.9000  
fax: 207.761.2010  
info@portcityarch.com

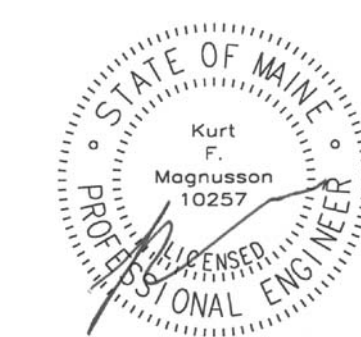

CONSULTANTS

Swiftcurrent Engineering Services Inc.  
10 Forest Fall Drive - unit 4B  
Yarmouth, Maine 04096  
(207) 847-9280  
contact: Tim Matthews, P.E.  
tim@swiftcurrenteng.com

Mechanical Systems Engineers  
10 Forest Fall Drive - suite 10  
Yarmouth, Maine 04096  
(207) 846-9441  
contact: Kurt Magnusson, P.E.  
kurt@mechanicalsystemseng.com

PERMIT SET  
10-21-16

NOT FOR  
CONSTRUCTION

NEWPORT  
DEVELOPMENT  
ASSOCIATES

164 Middle St  
Portland, Maine

| # | DATE | DESCRIPTION |
|---|------|-------------|
|   |      |             |
|   |      |             |
|   |      |             |
|   |      |             |
|   |      |             |
|   |      |             |
|   |      |             |
|   |      |             |
|   |      |             |
|   |      |             |

DATE ISSUED OCTOBER 21, 2016

PROJECT NUMBER 16207

DRAWING SCALE AS NOTED

SHEET NAME  
**MECHANICAL  
DETAILS &  
NOTES**

DRAWN BY  
KFM

CHECKED BY  
KFM

**M1.2**